

PRODUCTOS PARA INSTALACIONES ELECTRICAS

Products for electrical installations

INYECTADOS



RAWELT®

DIECAST



Cajas para áreas peligrosas libres de cobre



Cajas Ovais



Cajas Unión

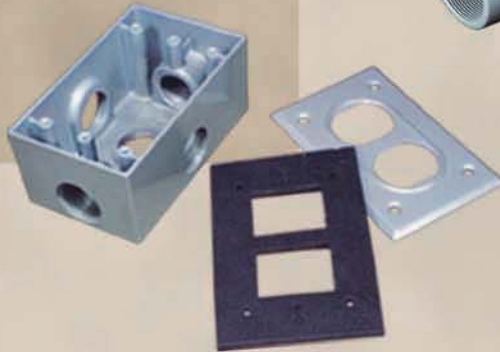

Cajas Rectangulares y Cuadradas



Luminarias a prueba de intemperie

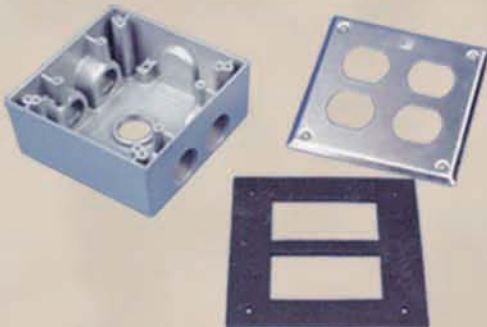

Tuercas Unión para áreas peligrosas



Sellos para áreas peligrosas



Luminaria Industrial HID para áreas peligrosas



Lámparas Luz de Obstrucción



Vaso de Cristal

Lámparas a prueba de vapor



Vaso de Policarbonato

Folleto RW 20

**4.3 - CAJA CUADRADA. A PRUEBA DE INTEMPERIE. SERIE RC.
CON RECUBRIMIENTO EXTERIOR DE PVC E INTERIOR DE URETANO PURPURA.**

**4.3 - WEATHERPROOF TWO GANG BOX. RC SERIES.
WITH PVC COATING AND PURPLE URETHANE INNER COATING.**

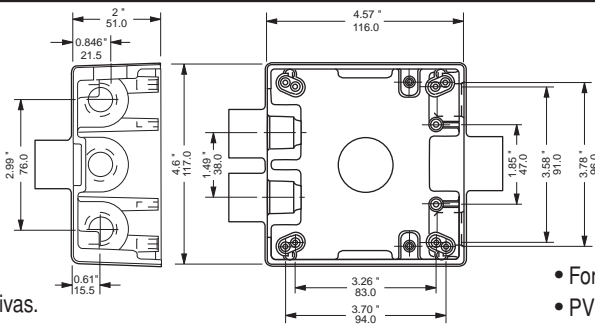

Dimensiones en milímetros y en pulgadas.
Dimensions in inches and millimeters.



LISTED
1M70



- A prueba de áreas corrosivas.
- Recubrimiento: PVC 40 mil. mínimo.
- Uretano PURPURA: 2 mil. mínimo.
- Mangas en las entradas para un sellado hermético.
- Material: Aluminio inyectado a presión (diecast).
- Rosca NPT para usarse con tubo conduit RIGIDO e IMC.
- Dos tornillos de tierra pasivados incluidos.
- A prueba de intemperie.

APLICACIONES:

- Pueden ser instaladas para recibir accesorios como: Interruptores, contactos, estaciones de botones, luces piloto.
- Sirven para hacer empalmes y conexiones en el cableado. Permite fácil acceso para mantenimiento.
- Fabricación en base a: UL 514 A, UL 514 B
CAN/CSA-C22.2 No. 18-92

- For use in corrosive atmospheres.
- PVC coating: 40 mil. mín.
- PURPLE Urethane: Interior protection: 2 mil. mín.
- Pressure sealing sleeves on conduit openings.
- Material: Diecast aluminum.
- Two green ground screws included.
- For wet location.
- NPT threaded for use with RIGID and IMC conduit.

APPLICATIONS:

- They can be installed to accommodate accessories such as switches, receptacles.
- Provide openings for making splice and taps. Allow access for maintenance.
- Manufactured in compliance with: UL 514 A, UL 514 B
CAN/CSA-C22.2 No. 18-92

USAR No. DE CODIGO PARA HACER PEDIDOS / TO ORDER USE CODE NUMBER

| Figura Figure | Bocas Hubs | Catalogo Catalog | Codigo Code | Medida nominal Hub size | | Volumen Volume | | Peso x 100 pzas. Weight x 100 pcs. | | Std Pkg. Pzas. Pcs. | |
|------------------|----------------|---------------------|----------------|----------------------------|------|-------------------|--------|---------------------------------------|----|------------------------------|--|
| | | | | mm | inch | cm ³ | cu. in | kg | Lb | | |
| | Arriba/Top | 1 | RC-0482-PC | 02.06.2853.PC | 12.7 | 1/2 | 492.0 | 30.0 | | | |
| | Abajo/Bottom | 1 | RC-0483-PC | 02.06.2854.PC | 19.0 | 3/4 | 492.0 | 30.0 | | | |
| | Arriba/Top | 2 | RC-0484-PC | 02.06.2855.PC | 12.7 | 1/2 | 483.8 | 29.5 | | | |
| | Abajo/Bottom | 1 | RC-0485-PC | 02.06.2856.PC | 19.0 | 3/4 | 483.8 | 29.5 | | | |
| | Arriba/Top | 1 | RC-0502-PC | 02.06.2873.PC | 12.7 | 1/2 | 492.0 | 30.0 | | | |
| | Abajo/Bottom | 1 | RC-0503-PC | 02.06.2874.PC | 19.0 | 3/4 | 492.0 | 30.0 | | | |
| | Izquierda/Left | 1 | RC-0503-PC | 02.06.2874.PC | 19.0 | 3/4 | 492.0 | 30.0 | | | |
| | Arriba/Top | 1 | RC-0486-PC | 02.06.2857.PC | 12.7 | 1/2 | 492.0 | 30.0 | | | |
| | Abajo/Bottom | 1 | RC-0487-PC | 02.06.2858.PC | 19.0 | 3/4 | 492.0 | 30.0 | | | |
| | Izquierda/Left | 1 | RC-0487-PC | 02.06.2858.PC | 19.0 | 3/4 | 492.0 | 30.0 | | | |
| | Derecha/Right | 1 | RC-0487-PC | 02.06.2858.PC | 19.0 | 3/4 | 492.0 | 30.0 | | | |
| | Arriba/Top | 2 | RC-0488-PC | 02.06.2859.PC | 12.7 | 1/2 | 475.0 | 29.5 | | | |
| | Abajo/Bottom | 1 | RC-0489-PC | 02.06.2860.PC | 19.0 | 3/4 | 475.0 | 29.5 | | | |
| | Izquierda/Left | 1 | RC-0489-PC | 02.06.2860.PC | 19.0 | 3/4 | 475.0 | 29.5 | | | |

Especificaciones sujetas a cambio sin previo aviso. Specifications are subject to change without notice.

RAWELT, S.A. de C.V.

Una División del Grupo REVUELTA



**4.3 - CAJA CUADRADA. A PRUEBA DE INTEMPERIE. SERIE RC.
CON RECUBRIMIENTO EXTERIOR DE PVC E INTERIOR DE URETANO PURPURA.**

**4.3 - WEATHERPROOF TWO GANG BOX. RC SERIES.
WITH PVC COATING AND PURPLE URETHANE INNER COATING.**

Hoja: 2 / 5
Page:

FICHA TECNICA / TECHNICAL DATA

007 - RW - 199

USAR No. DE CODIGO PARA HACER PEDIDOS / TO ORDER USE CODE NUMBER

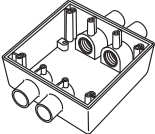
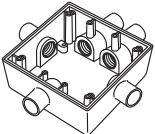
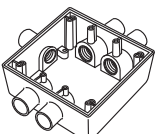
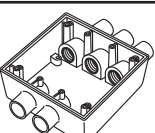
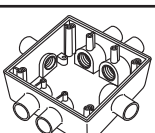
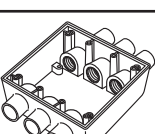
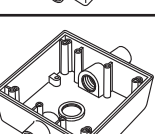
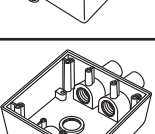
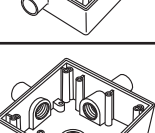
| Figura Figure | Bocas Hubs | Catalogo Catalog | Codigo Code | Medida nominal Hub size | | Volumen Volume | | Peso x 100 pzas. Weight x 100 pcs. | | | | | | Std Pkg. Pzas. Pcs. |
|--|------------------|---------------------|----------------|-------------------------------|------|-------------------|--------|---------------------------------------|----|--|--|--|--|------------------------------|
| | | | | mm | inch | cm ³ | cu. in | kg | Lb | | | | | |
|  | Arriba/Top 2 | RC-0492-PC | 02.06.2863.PC | 12.7 | 1/2 | 480.5 | 29.3 | | | | | | | |
| | Abajo/Bottom 2 | RC-0493-PC | 02.06.2864.PC | 19.0 | 3/4 | 480.5 | 29.3 | | | | | | | |
|  | Arriba/Top 2 | RC-0490-PC | 02.06.2861.PC | 12.7 | 1/2 | 483.8 | 29.5 | | | | | | | |
| | Abajo/Bottom 1 | | | | | | | | | | | | | |
| | Izquierda/Left 1 | RC-0491-PC | 02.06.2862.PC | 19.0 | 3/4 | 483.8 | 29.5 | | | | | | | |
| | Derecha/Right 1 | | | | | | | | | | | | | |
|  | Arriba/Top 2 | RC-0494-PC | 02.06.2865.PC | 12.7 | 1/2 | 480.5 | 29.3 | | | | | | | |
| | Abajo/Bottom 2 | | | | | | | | | | | | | |
| | Izquierda/Left 1 | RC-0495-PC | 02.06.2866.PC | 19.0 | 3/4 | 480.5 | 29.3 | | | | | | | |
|  | Arriba/Top 3 | RC-0498-PC | 02.06.2869.PC | 12.7 | 1/2 | 475.6 | 29.0 | | | | | | | |
| | Abajo/Bottom 2 | RC-0499-PC | 02.06.2870.PC | 19.0 | 3/4 | 475.6 | 29.0 | | | | | | | |
|  | Arriba/Top 2 | RC-0496-PC | 02.06.2867.PC | 12.7 | 1/2 | 480.5 | 29.3 | | | | | | | |
| | Abajo/Bottom 2 | | | | | | | | | | | | | |
| | Izquierda/Left 1 | RC-0497-PC | 02.06.2868.PC | 19.0 | 3/4 | 480.5 | 29.3 | | | | | | | |
| | Derecha/Right 1 | | | | | | | | | | | | | |
|  | Arriba/Top 3 | RC-0500-PC | 02.06.2871.PC | 12.7 | 1/2 | 472.3 | 28.8 | | | | | | | |
| | Abajo/Bottom 3 | RC-0501-PC | 02.06.2872.PC | 19.0 | 3/4 | 472.3 | 28.8 | | | | | | | |
|  | Arriba/Top 1 | RC-0279-PC | 02.06.2831.PC | 12.7 | 1/2 | 492.0 | 30.0 | | | | | | | |
| | Abajo/Bottom 1 | | | | | | | | | | | | | |
| | Detrás/Back 1 | RC-0280-PC | 02.06.2832.PC | 19.0 | 3/4 | 492.0 | 30.0 | | | | | | | |
|  | Arriba/Top 2 | RC-0327-PC | 02.06.2833.PC | 12.7 | 1/2 | 483.8 | 29.5 | | | | | | | |
| | Abajo/Bottom 1 | | | | | | | | | | | | | |
| | Detrás/Back 1 | RC-0328-PC | 02.06.2834.PC | 19.0 | 3/4 | 483.8 | 29.5 | | | | | | | |
|  | Arriba/Top 1 | RC-0406-PC | 02.06.2851.PC | 12.7 | 1/2 | 492.0 | 30.0 | | | | | | | |
| | Abajo/Bottom 1 | | | | | | | | | | | | | |
| | Izquierda/Left 1 | RC-0407-PC | 02.06.2852.PC | 19.0 | 3/4 | 492.0 | 30.0 | | | | | | | |
| | Detrás/Back 1 | | | | | | | | | | | | | |

Especificaciones sujetas a cambio sin previo aviso. Specifications are subject to change without notice.

RAWELT, S.A. de C.V.

Una División del Grupo **REVUELTA**

RAWELT
PURPURA® COAT

22 - v - 2009

**4.3 - CAJA CUADRADA. A PRUEBA DE INTEMPERIE. SERIE RC.
CON RECUBRIMIENTO EXTERIOR DE PVC E INTERIOR DE URETANO PURPURA.**

Hoja: 3 / 5
Page:

**4.3 - WEATHERPROOF TWO GANG BOX. RC SERIES.
WITH PVC COATING AND PURPLE URETHANE INNER COATING.**

FICHA TECNICA / TECHNICAL DATA

007-RW-199

USAR No. DE CODIGO PARA HACER PEDIDOS / TO ORDER USE CODE NUMBER

| Figura Figure | Bocas Hubs | Catalogo Catalog | Codigo Code | Medida nominal Hub size | | Volumen Volume | | Peso x 100 pzas. Weight x 100 pcs. | | Std Pkg. Pzas. Pcs. | | | | |
|------------------|----------------|---------------------|----------------|----------------------------|------|-------------------|--------|---------------------------------------|----|------------------------------|--|--|--|--|
| | | | | mm | inch | cm ³ | cu. in | kg | Lb | | | | | |
| | Arriba/Top | 1 | RC-0390-PC | 02.06.2835.PC | 12.7 | 1/2 | 492.0 | 30.0 | | | | | | |
| | Abajo/Bottom | 1 | | | | | | | | | | | | |
| | Izquierda/Left | 1 | RC-0391-PC | 02.06.2836.PC | 19.0 | 3/4 | 492.0 | 30.0 | | | | | | |
| | Derecha/Right | 1 | | | | | | | | | | | | |
| Detrás/Back | 1 | | | | | | | | | | | | | |
| | Arriba/Top | 2 | RC-0392-PC | 02.06.2837.PC | 12.7 | 1/2 | 483.8 | 29.5 | | | | | | |
| | Abajo/Bottom | 1 | | | | | | | | | | | | |
| | Izquierda/Left | 1 | RC-0393-PC | 02.06.2838.PC | 19.0 | 3/4 | 483.8 | 29.5 | | | | | | |
| | Detrás/Back | 1 | | | | | | | | | | | | |
| | Arriba/Top | 2 | RC-0396-PC | 02.06.2841.PC | 12.7 | 1/2 | 480.5 | 29.3 | | | | | | |
| | Abajo/Bottom | 2 | | | | | | | | | | | | |
| | Detrás/Back | 1 | RC-0397-PC | 02.06.2842.PC | 19.0 | 3/4 | 480.5 | 29.3 | | | | | | |
| | | | | | | | | | | | | | | |
| | Arriba/Top | 2 | RC-0394-PC | 02.06.2839.PC | 12.7 | 1/2 | 483.8 | 29.5 | | | | | | |
| | Abajo/Bottom | 1 | | | | | | | | | | | | |
| | Izquierda/Left | 1 | RC-0395-PC | 02.06.2840.PC | 19.0 | 3/4 | 483.8 | 29.5 | | | | | | |
| | Derecha/Right | 1 | | | | | | | | | | | | |
| Detrás/Back | 1 | | | | | | | | | | | | | |
| | Arriba/Top | 2 | RC-0398-PC | 02.06.2843.PC | 12.7 | 1/2 | 480.5 | 29.3 | | | | | | |
| | Abajo/Bottom | 2 | | | | | | | | | | | | |
| | Izquierda/Left | 1 | RC-0399-PC | 02.06.2844.PC | 19.0 | 3/4 | 480.5 | 29.3 | | | | | | |
| | Detrás/Back | 1 | | | | | | | | | | | | |
| | Arriba/Top | 3 | RC-0402-PC | 02.06.2847.PC | 12.7 | 1/2 | 475.6 | 29.0 | | | | | | |
| | Abajo/Bottom | 2 | | | | | | | | | | | | |
| | Detrás/Back | 1 | RC-0403-PC | 02.06.2848.PC | 19.0 | 3/4 | 475.6 | 29.0 | | | | | | |
| | | | | | | | | | | | | | | |
| | Arriba/Top | 2 | RC-0400-PC | 02.06.2845.PC | 12.7 | 1/2 | 480.5 | 29.3 | | | | | | |
| | Abajo/Bottom | 2 | | | | | | | | | | | | |
| | Izquierda/Left | 1 | RC-0401-PC | 02.06.2846.PC | 19.0 | 3/4 | 480.5 | 29.3 | | | | | | |
| | Derecha/Right | 1 | | | | | | | | | | | | |
| Detrás/Back | 1 | | | | | | | | | | | | | |
| | Arriba/Top | 3 | RC-0404-PC | 02.06.2849.PC | 12.7 | 1/2 | 472.3 | 28.8 | | | | | | |
| | Abajo/Bottom | 3 | | | | | | | | | | | | |
| | Detrás/Back | 1 | RC-0405-PC | 02.06.2850.PC | 19.0 | 3/4 | 472.3 | 28.8 | | | | | | |
| | | | | | | | | | | | | | | |

Certificaciones / Compliances:



Expediente/File No. LR 105795-1



Expediente/File No. E135600

Especificaciones sujetas a cambio sin previo aviso. Specifications are subject to change without notice.

RAWELT, S.A. de C.V.

Una División del Grupo **REVUELTA**

RAWELT
PURPURA COAT

16 - VI - 2009

**4.3 - CAJA CUADRADA. A PRUEBA DE INTEMPERIE. SERIE RC.
CON RECUBRIMIENTO EXTERIOR DE PVC E INTERIOR DE URETANO PURPURA.**

Hoja: 4 / 5
Page:

**4.3 - WEATHERPROOF TWO GANG BOX. TWO GANG. RC SERIES.
WITH PVC COATING AND PURPLE URETHANE INNER COATING.**

FICHA TECNICA / TECHNICAL DATA

007-RW-199

TAPA

- Recubrimiento: PVC 40 mil. mínimo.
- Uretano PURPURA 2 mil. mínimo.
- Lámina de aluminio troquelada.
- Tornillos de acero inoxidable incluidos.

COVER

- PVC coating: 40 mil. mín.
- PURPLE Urethane: 2 mil. mín.
- Sheet aluminum.
- Stainless steel screws included.

TAPON

- Aluminio inyectado a presión.(die cast)

CLOSE UP PLUG

- Die cast aluminum.

Dimensiones en milímetros y pulgadas.
Dimensions in inches and millimeters.

4 Ø de 3mm.
0.11"

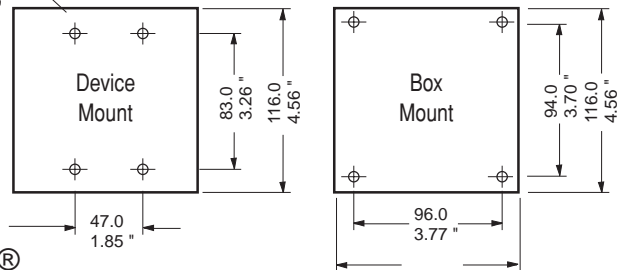

Peso x 100 pzas.
Weight x 100 pcs.

USAR No. DE CODIGO PARA HACER PEDIDOS / TO ORDER USE CODE NUMBER

| Figura Figure | Catalogo Catalog | Codigo Code | Descripción Description | Cant. Diam. Qty. | Espesor Thickness | | Peso x 100 pzas. Weight x 100 pcs. | | Unit. Ctn. Pzas. Pcs. | Ship Ctn. Pzas. Pcs. | Std. Pkg. Pzas. Pcs. |
|------------------|---------------------|----------------|--|------------------------|----------------------|-------|---------------------------------------|----|--------------------------------|-------------------------------|-------------------------------|
| | | | | | mm | inch. | kg | Lb | | | |
| | TC-0417-PC | 02.07.2875.PC | Tapa cuadrada para dos contactos duplex. Two gang two duplex receptacles cover. Box mount. | 4 | 1.02 | .040 | | | 30 | 90 | |
| | TC-0457-PC | 02.07.2878.PC | Tapa cuadrada para dos contactos duplex. Two gang two duplex receptacles cover. Device mount. | 2 | 1.02 | .040 | | | 30 | 90 | |
| | TC-0419-PC | 02.07.2877.PC | Tapa cuadrada para dos interruptores. Two gang two toggles switches cover. Box mount. | 4 | 1.02 | .040 | | | 30 | 90 | |
| | TC-0459-PC | 02.07.2880.PC | Tapa cuadrada para dos interruptores. Two gang two toggles switches cover. Device mount. | 4 | 1.02 | .040 | | | 30 | 90 | |
| | TC-0510-PC | 02.07.2881.PC | Tapa cuadrada para contacto duplex y apagador. Two gang toggle switch and duplex receptaclecover. Box mount. | 4 | 1.02 | .040 | | | 30 | 90 | |
| | TC-0511-PC | 02.07.2882.PC | Tapa cuadrada para contacto duplex y apagador. Two gang toggle switch and duplex receptaclecover. Device mount. | 3 | 1.02 | .040 | | | 30 | 90 | |
| | TC-0418-PC | 02.07.2876.PC | Tapa cuadrada ciega. Weatherproof two gang blank cover. Box mount. | 4 | 1.02 | .040 | | | 30 | 90 | |
| | TC-0458-PC | 02.07.2879.PC | Tapa cuadrada ciega. Weatherproof two gang blank cover. Device mount. | 4 | 1.02 | .040 | | | 30 | 90 | |

Especificaciones sujetas a cambio sin previo aviso. Specifications are subject to change without notice.

RAWELT, S.A. de C.V.

Una División del Grupo REVUELTA

RAWELT
PURPURA COAT

16 - VI - 2009

**4.3 - CAJA CUADRADA. A PRUEBA DE INTEMPERIE. SERIE RC.
CON RECUBRIMIENTO EXTERIOR DE PVC E INTERIOR DE URETANO PURPURA.**

**4.3 - WEATHERPROOF TWO GANG BOX. RC SERIES.
WITH PVC COATING AND PURPLE URETHANE INNER COATING.**

Hoja: 5 / 5
Page:

FICHA TECNICA / TECHNICAL DATA

007-RW-199

USAR No. DE CODIGO PARA HACER PEDIDOS / TO ORDER USE CODE NUMBER

| Figura Figure | Catalogo Catalog | Codigo Code | Descripción Description | Cant. Diam. Qty. | Medida nominal Hub size | | Peso x 100 pzas. Weight x 100 pcs. | | Pqt. Unit Pzas. Pcs. | Unit Ctn. Pzas. Pcs. | Ship Ctn. Pzas. Pcs. | Std. Pkg. Pzas. Pcs. |
|---|---------------------|----------------|----------------------------|------------------------|-------------------------------|------|---------------------------------------|----|-------------------------------|-------------------------------|-------------------------------|-------------------------------|
| | | | | | mm | inch | kg | Lb | | | | |
|  | TA-0371-EX | 01.09.2829.EX | Tapón roscado | | 12.7 | 1/2 | | | 25 | 200 | 2000 | |
| | TA-0368-EX | 01.09.2828.EX | Close-up plug. | | 19.0 | 3/4 | | | 25 | 100 | 1000 | |

Certificaciones / Compliances:  Expediente/File No. LR 105795-1  Expediente/File No. E135600

Especificaciones sujetas a cambio sin previo aviso. Specifications are subject to change without notice.

RAWELT, S.A. de C.V.

Una División del Grupo **REVUELTA** 

 **RAWELT**
PURPURA 

22 - V - 2009

Cotización/Quotation Plazo de embarque* / Shipment exw* :

Pedido No./Purchase order :

Our ref.:

Fecha/Date: Vendedor/Salesman: No.

Facturar a/Invoice to: RFC.

Ordenado por/Ordered by: Tel. () Fax ()

Dirección/Address:

C.P./Zip: Lugar/City/Country:

Consignar a/Ship to:

Embarcar: Camión x Cobrar Pagado Paquete

Cond. de Pago/Terms:

Cond. de Venta/Sale conditions: L.P.:

4.3 - SERIE RC - PC. CAJA CUADRADA A PRUEBA DE INTEMPERIE. CON PVC / WEATHERPROOF TWO GANG BOX. WITH PVC COATING.

| Figura Figure | Código Code | Medida nominal Hub size | | Pqt. Unit. Pzas. Pcs. | Unit. Ctn. Pzas. Pcs. | Ship Ctn. Pzas. Pcs. | Std. Pkg. Pzas. Pcs. | Cantidad Qty. | Figura Figure | Código Code | Medida nominal Hub size | | Std. Pkg. Pzas. Pcs. | Cantidad Qty. |
|------------------|----------------|----------------------------|------|--------------------------------|--------------------------------|-------------------------------|-------------------------------|------------------|------------------|----------------|----------------------------|------|-------------------------------|------------------|
| | | mm | inch | | | | | | | | mm | inch | | |
| | 02.06.2853.PC | 12.7 | 1/2 | | | | | | | 02.06.2831.PC | 12.7 | 1/2 | | |
| | 02.06.2854.PC | 19.0 | 3/4 | | | | | | | 02.06.2832.PC | 19.0 | 3/4 | | |
| | 02.06.2855.PC | 12.7 | 1/2 | | | | | | | 02.06.2833.PC | 12.7 | 1/2 | | |
| | 02.06.2856.PC | 19.0 | 3/4 | | | | | | | 02.06.2834.PC | 19.0 | 3/4 | | |
| | 02.06.2873.PC | 12.7 | 1/2 | | | | 16 | | | 02.06.2851.PC | 12.7 | 1/2 | | |
| | 02.06.2874.PC | 19.0 | 3/4 | | | | 16 | | | 02.06.2852.PC | 19.0 | 3/4 | | |
| | 02.06.2857.PC | 12.7 | 1/2 | | | | | | | 02.06.2835.PC | 12.7 | 1/2 | | |
| | 02.06.2858.PC | 19.0 | 3/4 | | | | | | | 02.06.2836.PC | 19.0 | 3/4 | | |
| | 02.06.2859.PC | 12.7 | 1/2 | | | | | | | 02.06.2837.PC | 12.7 | 1/2 | | |
| | 02.06.2860.PC | 19.0 | 3/4 | | | | | | | 02.06.2838.PC | 19.0 | 3/4 | | |
| | 02.06.2863.PC | 12.7 | 1/2 | | | | 16 | | | 02.06.2841.PC | 12.7 | 1/2 | | |
| | 02.06.2864.PC | 19.0 | 3/4 | | | | 16 | | | 02.06.2842.PC | 19.0 | 3/4 | | |
| | 02.06.2861.PC | 12.7 | 1/2 | | | | | | | 02.06.2839.PC | 12.7 | 1/2 | | |
| | 02.06.2862.PC | 19.0 | 3/4 | | | | | | | 02.06.2840.PC | 19.0 | 3/4 | | |
| | 02.06.2865.PC | 12.7 | 1/2 | | | | | | | 02.06.2843.PC | 12.7 | 1/2 | | |
| | 02.06.2866.PC | 19.0 | 3/4 | | | | | | | 02.06.2844.PC | 19.0 | 3/4 | | |
| | 02.06.2869.PC | 12.7 | 1/2 | | | | | | | 02.06.2847.PC | 12.7 | 1/2 | | |
| | 02.06.2870.PC | 19.0 | 3/4 | | | | | | | 02.06.2848.PC | 19.0 | 3/4 | | |
| | 02.06.2867.PC | 12.7 | 1/2 | | | | | | | 02.06.2845.PC | 12.7 | 1/2 | | |
| | 02.06.2868.PC | 19.0 | 3/4 | | | | | | | 02.06.2846.PC | 19.0 | 3/4 | | |
| | 02.06.2871.PC | 12.7 | 1/2 | | | | | | | 02.06.2849.PC | 12.7 | 1/2 | | |
| | 02.06.2872.PC | 19.0 | 3/4 | | | | | | | 02.06.2850.PC | 19.0 | 3/4 | | |
| | 01.09.2829.EX | 12.7 | 1/2 | 25 | 200 | 2000 | | | | | | | | |
| | 01.09.2828.EX | 19.0 | 3/4 | 25 | 100 | 1000 | | | | | | | | |

• Antes de fincar el pedido en firme, favor de confirmar con fábrica el plazo de embarque definitivo.
 • Before place your order, please confirm with RAWELT definitive date of shipment.

Expediente Control Embarques Almacén Producción